

VCD SERIES ADJUSTABLE CHECK VALVE

Design Specification

Product Code	Working Pressure, psig (bar) @ 70°F (21°C)	
	SS316	Brass
VCD	3,000 (206)	3,000 (206)

Temperature Range, °F (°C)

- FKM O-ring: -10 to 375 (-23 to 190) for SS316
- Buna N O-ring: -10 to 250 (-23 to 121) for Brass

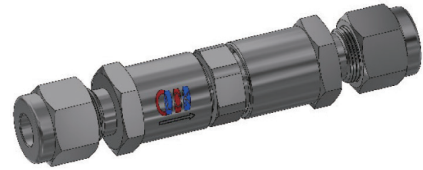

Cracking and Reseal Pressure @ 70°F (21°C)

Designator	Cracking Pressure Range, psig (bar)
3	3 to 50 (0.2 to 3.4)
50	50 to 150 (3.4 to 10.3)
150	150 to 350 (10.3 to 24.1)
350	350 to 600 (24.1 to 41.3)

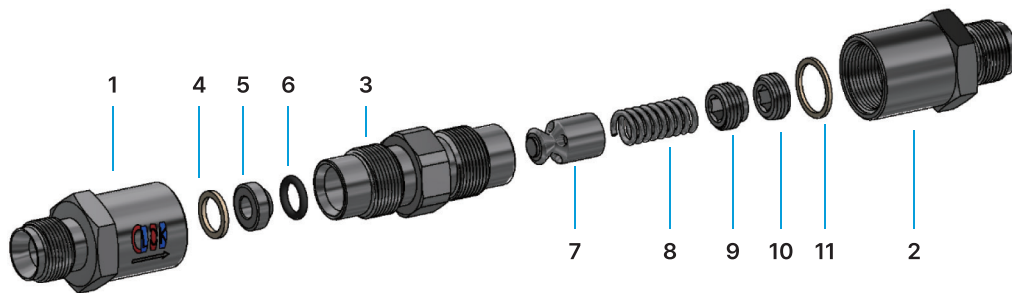
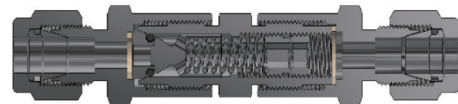

Material of Construction

No.	Description	Based on body material, ASTM Std.	
		SS316	Brass
1	Inlet Body*	A276 Type316	B16 Brass360
2	Outlet Body*	A276 Type316	B16 Brass360
3	Center body*	A276 Type316	B16 Brass360
4	Inlet Seal	SS316 with PTFE	SS316 with PTFE
5	Insert*	A276 Type316	B16 Brass360
6	O-ring*	FKM	Buna N
7	Poppet*	A276 Type316	B16 Brass360
8	Spring*	Stainless Steel 302	Stainless Steel 302
9	Adjusting Screw*	A276 Type316	A276 Type316
10	Locking Screw*	A276 Type316	A276 Type316
11	Outlet Seal*	SS316 with PTFE	SS316 with PTFE

Note:

- Wetted part is marked with "*" in the description list.
- The threads of outlet body are coated with molybdenum.
- O-ring are coated with silicone based lubricant.

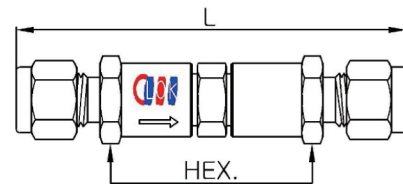

Product Code & Dimensions

Product Code	End Connections	End Connections	Orifice	Cv	Dimension	
					L	HEX.
VCD	ML4T	M-LOK 1/4"	4.8	0.37	82.0	5/8"
	ML6M	M-LOK 6mm	4.8	0.37	82.0	5/8"
	ML8M	M-LOK 8mm	4.8	0.37	84.3	5/8"
	M4N	Male NPT 1/4"	4.8	0.37	79.2	5/8"

Note:

- All dimensions are in millimeters and may be changed for reference only.
- In the case of M-LOK tube fittings, these are dimensions in a finger-tight.
- End connections and sizes not listed in the table above can be made to order.

Ordering Information

VCG3	ML8T	1/3	V	SS
Body Size	End Connection	Cracking Pressure Designator	O-ring	Body Material
			V: FKM N: Buna N	SS: SS316 B: Brass